



Beautiful Women

Design by Marcel Wanders

Beautiful Women by Marcel Wanders signals the return of a type of furniture that has all but disappeared. The series consists of a mirror with a richly decorated frame and a glass shelf, a small dresser in two variations, a stool and side table. 'Elle Decoration' selected 'Ken Stool' as 'Future Classic'.

The sober dresser features a sunken top and cast brass handles in the shape of an apple and a snake, a reference to the first woman. The more baroque cabinet features a spherical, massive wooden foot on which a top has been fitted. The stool and its side table version, with its graphic design and round forms, refer to the 1960s.

The series is a post-modern ensemble intended as a tribute to womankind.



About the designer

Marcel Wanders (Boxtel, 1963) graduated cum laude from the Hogeschool voor de Kunsten (Artez Institute of the Arts) in Arnhem in 1988 after being expelled from Eindhoven Design Academy. In 1995 he opened his studio in the beating heart of the Dutch capital, Amsterdam, quickly coming to worldwide attention in 1996 for his iconic 'Knotted Chair' which paired high tech materials with 'low tech' production methods.

Today Marcel's powerhouse studio numbers around 50 international design specialists, and he is a prolific product and interior designer and art director, ubiquitous with over 1700+ projects to his name.

Regarded by many as an anomaly in the design world, Marcel has made it his mission to "create an environment of love, live with passion and make our most exciting dreams come true." His work excites, provokes, and polarises, but never fails to surprise for its ingenuity, daring and singular quest to uplift the human spirit, and entertain.

quodes®

Ken Side Table

Dimensions & Materials

The side table has a height of 38 cm. The glass top has a diameter of 40 cm.

The table top is made of reinforced glass.

The base is laser cut and powder coated in black. The surface of the powder coating has a light 'orange skin'.

The base is invisibly welded to the bottom and top plate.

An anodized aluminum part is invisibly UV glued to the glass table top. This aluminum part is invisibly connected with screws to the base.

Colours

Satin black is the standard colour. Other colours upon request (for bigger quantities).

Mounting

Under the base plate 4 rubber devices are glued, which provide a solid protection for many floors. We strongly recommend to check the specifications of your floor and glue other specific protection material under the plate, if required.

Delivery

Ken is delivered in 2 coli (base + glass top). For some export destinations, we deliver in a wooden crate.

Maintenance

Base: dust with a soft, dry cloth. If required, clean with soapy water. Never use any chemical cleaning liquids and / or abrasives.

Glass top: clean with liquids especially made for glass. Be careful with sharp objects.



quodes®

Ken Stool

Dimensions & Materials

The height of the Ken Stool is 46 cm. The diameter of the seat is 38 cm. The seat is covered with the fabric 'Sudden' from 'Kvadrat'. Other fabrics upon request.

The base is laser cut and powder coated in black. The surface of the powder coating has a light 'orange skin'. The steel of the upright base is 12 mm thick.

The base is invisibly welded to the bottom and top plate. On top of the metal top plate, the seating is mounted (and can be demounted). The base is slightly flexible, which provides extra comfort.

Colours

Model "Ken Sudden Silver": seating covered with fabric 'Kvadrat Sudden 002' (silver).

Model "Ken Sudden Bronze": seating covered with fabric 'Kvadrat Sudden 015' (brown / bronze).

Other colours can be delivered upon request. The base can also be powder coated in other colours (usually for bigger quantities) upon request.

Mounting

The base plate rests on 4 rubber pads, providing protection for many floors. If needed, additional (household) pads can be placed to protect your floor.

Delivery

Ken is delivered in an export quality carton. For some export destinations, we deliver in a wooden crate.

Maintenance

Base: dust with a dry, soft cloth. If required, clean with soapy water. Never use any chemical cleaning liquids and / or abrasives.

Fabric: 'Sudden' from 'Kvadrat' is 100% polyurethane, with a polyester base. When cleaning, wipe the surface with a dry or moist cloth. Avoid any contact with sharp objects and hot or chemical liquids.



Seating covered with 'Kvadrat Sudden 015'



Seating covered with 'Kvadrat Sudden 002'

quodes®

Paris Mirror

Dimensions & Features

Mirror: L130, H84, D11 cm.

Paris is delivered with or without a glass shelf, which is glued to the mirror crystal.

Materials

The frame is made from high density 100% pure polyurethane and mirror glass. The glass shelf (which is optional) is glued to the mirror by UV technique.

Colours

The standard colour for the mirror is satin black or satin white (RAL 9016). Gold or other colours upon request.

Mounting

On the back of the mirror you'll be able to find a metal support, which allows mounting to the wall.

Make sure that the mirror is well mounted to the wall. If the mounting is inadequate, this can cause serious injuries.

Delivery

Paris is first packaged in a carton with protective foam. The carton is packaged in a strong, wooden frame.

Maintenance

Clean the frame with water and, if required, some soap.

For the glass you can use special cleaning materials, but DO NOT use acid or corrosive solvents. This will cause damage to the lacquering / frame itself.



Black, with shelve



White, with shelve

quodes®

Jen Side Table / Dresser

For projects only, minimum order quantity is 10 pcs.

Dimensions & Features

The length of Jen is 70 cm, the height is 59 cm and the depth is 40 cm. Jen features 2 open storage partitions, divided by a separation panel of 70 cm.

Materials

The base is made of solid ash wood and the top of MDF with ash wood veneer, which is stained in colour. When stained in red or black, the visible wood structure looks exactly the same as solid oak. Ash wood is extremely durable and the humidity percentage of the purchased solid wood is excellent for high quality manufacturing.

Colours

Stained in satin black or satin red.

Mounting

The spherical foot can be screwed on the top.

Delivery

We deliver Jen in 2 well developed carton boxes (top + foot). The carton has the highest possible export quality.

For some export destinations, we deliver in a wooden crate.

Maintenance

The cabinets are made of high quality solid wood and veneer. Solid wood has its own natural characteristics and may show knots, deformations and black spots. Open defects are allowed in non-visible areas to the extent that the normal product strength is not influenced.

Solid wood 'works', which means that over time natural little cracks may appear. A constant temperature and humidity of the air are important for a 'lifetime' preservation.

For the optimal preservation, it is important to avoid any contact with sharp objects and hot or chemical liquids. Remove moist spots as soon as possible. Keep the surfaces clean with a dry, cotton cloth. If required, use a moist cloth or a little bit of soapy water; clean in the direction of the wood structure and finish the cleaning with a dry cloth again. Never use any chemical cleaning liquids and / or abrasives. Remove liquids preferably within 15 minutes.



Stained in satin black



Stained in satin red

quodes®

Kate Dresser / Bedside Table

For projects only, minimum order quantity: 10 pcs.

Dimensions

The length of Kate is 50 cm, the height is 72 cm and the depth is 31 cm. Kate features a sunken top, which allows practical storage. It has 2 drawers and one inlay, from which the bottom is covered with white leather.

Materials & Colours

The dresser is available in solid ash wood, stained in black or (on request) solid walnut, mat lacquered, with in both cases the top and the drawer fronts lacquered in satin white. The handles are made of solid brass. Stem of the apple, tongue / tail of snake a 'realistic' and therefore a little sharp. The white leather is retained from a cow.

Note regarding ash wood: when stained in colour, the beautiful wood structure has exactly the same character as solid oak. In addition, ash wood is extremely durable (like the wooden grip of a hammer) and the humidity percentage of the purchased solid wood is excellent for high quality manufacturing.

Delivery

We deliver Kate in a carton packaging, including several internal supports. The carton has the highest possible export quality. For some export destinations, we deliver in a wooden crate.

Maintenance

The cabinets are made of high quality solid wood. Solid wood has its own natural characteristics and may show knots, deformations and black spots. Open defects are allowed in non-visible areas to the extent that the normal product strength is not influenced.

Solid wood 'works', which means that over time natural little cracks may appear. A constant temperature and humidity of the air are important for a 'lifetime' preservation.

For the optimal preservation, it is important to avoid any contact with sharp objects and hot or chemical liquids. Remove moist spots as soon as possible. Keep the surfaces clean with a dry, cotton cloth. If required, use a moist cloth or a little bit of soapy water; clean in the direction of the wood structure and finish the cleaning with a dry cloth again. Never use any chemical cleaning liquids and / or abrasives. Remove liquids preferably within 15 minutes.



Solid walnut



Solid ash wood

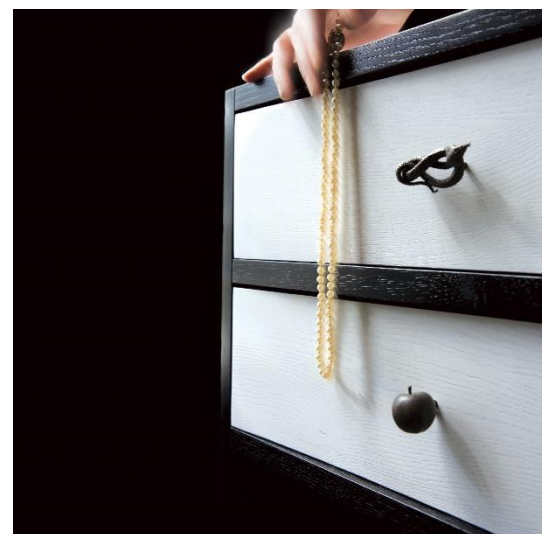

Handles

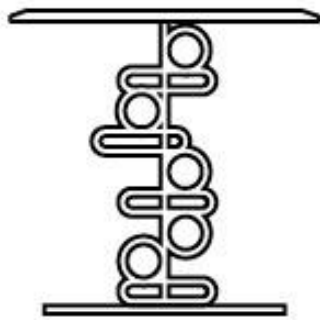

Ken Side Table
H46 Ø40 cm

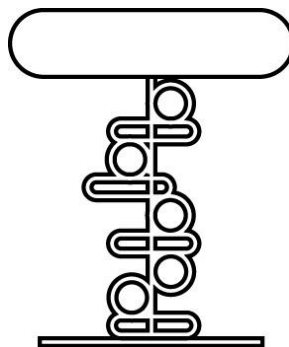

Ken Stool
H46 Ø38 cm

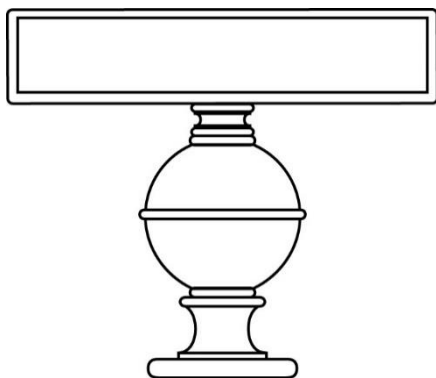

Jen
L70 H59 D40 cm

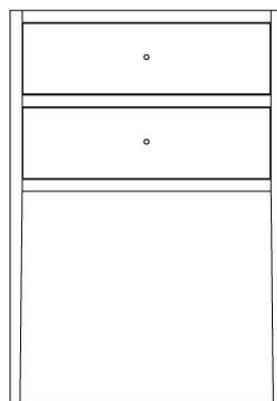

Kate
L50 H72 D31 cm

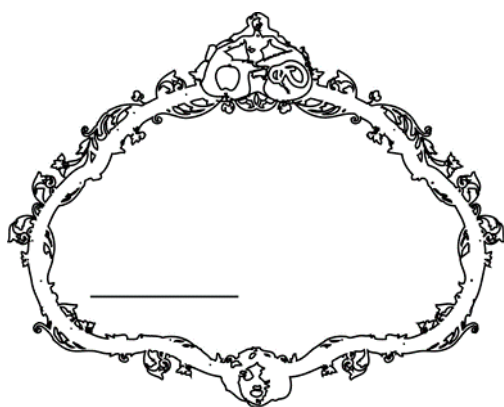

Paris
L130 H84 D11 cm